

Palm Aire 27

2651 S Palm Aire Dr, Pompano Beach, FL, Broward 33069

Building Information

Number of units:	40
Number of active listings for rent:	1
Number of active listings for sale:	4
Building inventory for sale:	10%
Number of sales over the last 12 months:	4
Number of sales over the last 6 months:	0
Number of sales over the last 3 months:	0

Palm Aire
2600 Palm Aire Drive North
Pompano Beach, FL 33069
Administration 954-975-6225

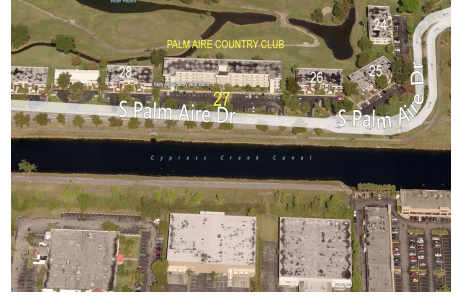

Built in 1973 - 40 units - 4 floors

Market Information

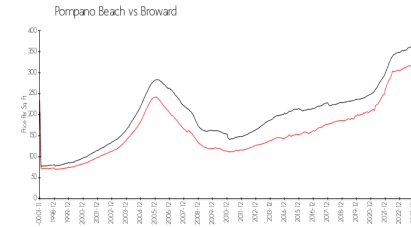
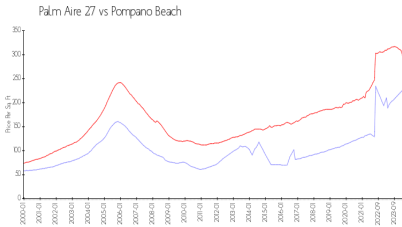

Palm Aire 27: \$226/sq. ft.
Pompano Beach: \$298/sq. ft.

Pompano Beach: \$298/sq. ft.
Broward: \$349/sq. ft.

Inventory for Sale

Palm Aire 27	10%
Pompano Beach	3%
Broward	3%

Avg. Time to Close Over Last 12 Months

Palm Aire 27	56 days
Pompano Beach	71 days
Broward	66 days