

Unit 1005 - Waterbury

1005 - 1401 N Riverside Dr, Pompano Beach, FL, Broward 33062

Unit Information

MLS Number: A11852485
 Status: Active
 Size: 1,002 Sq ft.
 Bedrooms: 2
 Full Bathrooms: 2
 Half Bathrooms: 0
 Parking Spaces: 1 Space, Additional Spaces Available, Assigned Parking

View:
 List Price: \$394,900
 List PPSF: \$394
 Valuated Price: \$364,000
 Valuated PPSF: \$308

The above valuated price is a baseline figure that does not take into account any specific renovation, upgrade, split, merge, or deterioration of the unit.

Building Information

Number of units: 84
 Number of active listings for rent: 0
 Number of active listings for sale: 4
 Building inventory for sale: 4%
 Number of sales over the last 12 months: 4
 Number of sales over the last 6 months: 2
 Number of sales over the last 3 months: 0

Building Association Information

The Waterbury Condominium
 Association Inc
 1401 N Riverside Drive # 1001
 Pompano Beach, FL 33062
 (954) 785-6028

<https://>

Recent Sales

Unit #	Size	Closing Date	Sale Price	PPSF
502	1,002 sq ft	Sep 2025	\$300,000	\$299
207	1,240 sq ft	Jul 2025	\$290,000	\$234
1106	1,002 sq ft	May 2025	\$320,000	\$319
Ph 1502	1,668 sq ft	Mar 2025	\$525,000	\$315

Market Information

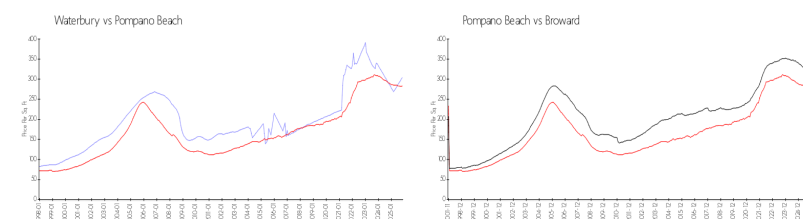

Waterbury:	\$304/sq. ft.	Pompano Beach:	\$283/sq. ft.
Pompano Beach:	\$283/sq. ft.	Broward:	\$311/sq. ft.

Inventory for Sale

Waterbury	5%
Pompano Beach	3%
Broward	4%

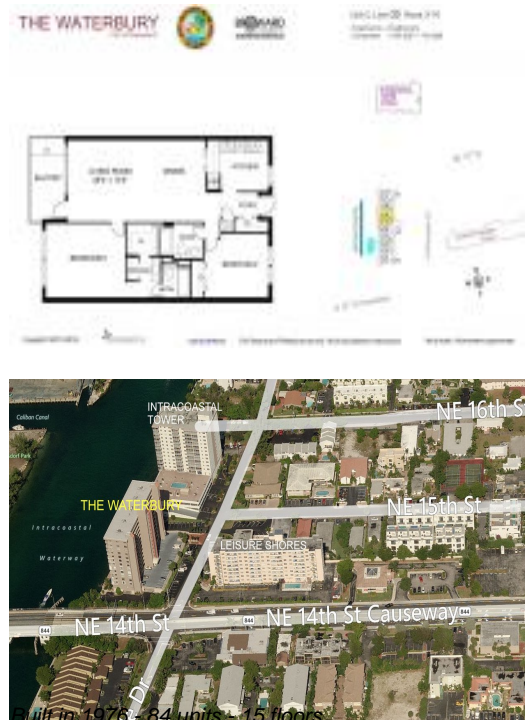

Avg. Time to Close Over Last 12 Months

Waterbury	139 days
Pompano Beach	88 days
Broward	87 days