

# Unit 1005 - Waterford Point

1005 - 801 S Federal Hwy, Pompano Beach, FL, Broward 33062

## Unit Information

MLS Number:	F10442513
Status:	Active
Size:	815 Sq ft.
Bedrooms:	1
Full Bathrooms:	1
Half Bathrooms:	1
Parking Spaces:	1 Space, Guest Parking
View:	Canal
List Price:	\$249,900
List PPSF:	\$307
Valuated Price:	\$243,000
Valuated PPSF:	\$298

*The above valuated price is a baseline figure that does not take into account any specific renovation, upgrade, split, merge, or deterioration of the unit.*

## Building Information

Number of units:	237
Number of active listings for rent:	2
Number of active listings for sale:	14
Building inventory for sale:	5%
Number of sales over the last 12 months:	4
Number of sales over the last 6 months:	3
Number of sales over the last 3 months:	2

## Building Association Information

Waterford Point Condominium Apartments  
801 S Federal Highway Apartment Mgr  
Pompano Beach, FL 33062-6769  
(954) 495-9721

<http://www.waterfordpoint.com/>

## Recent Sales

Unit #	Size	Closing Date	Sale Price	PPSF
PH10	1,210 sq ft	Sep 2024	\$375,000	\$310
815	1,210 sq ft	Jul 2024	\$419,000	\$346
1121	1,070 sq ft	Jun 2024	\$380,000	\$355
621	1,070 sq ft	Oct 2023	\$370,000	\$346

## Market Information

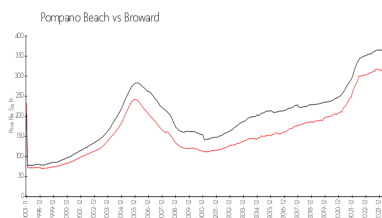
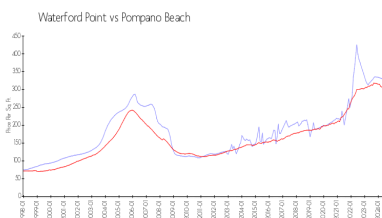

Waterford Point:	\$292/sq. ft.	Pompano Beach:	\$286/sq. ft.
Pompano Beach:	\$286/sq. ft.	Broward:	\$351/sq. ft.

## Inventory for Sale

Waterford Point	6%
Pompano Beach	4%
Broward	4%

## Avg. Time to Close Over Last 12 Months

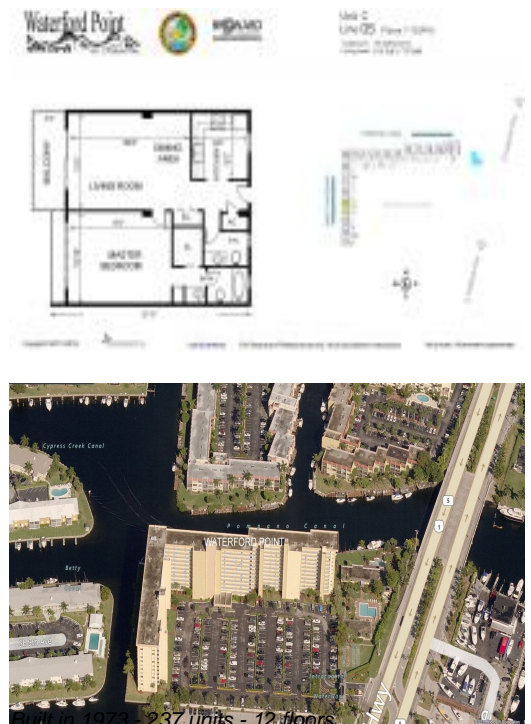

Waterford Point  
Pompano Beach  
Broward

63 days  
77 days  
72 days