

# Unit 2328 - Villa Sonoma at International Plaza

2328 - 4221 W Spruce St, Tampa, FL, Hillsborough 33607

## Unit Information

MLS Number: T3525794  
 Status: ACTIVE  
 Size: 996 Sq ft.  
 Bedrooms: 2  
 Full Bathrooms: 1  
 Half Bathrooms: 0  
 Parking Spaces:  
 View: Garden  
 List Price: \$309,000  
 List PPSF: \$310  
 Valuated Price: \$222,000  
 Valuated PPSF: \$223

*The above valuated price is a baseline figure that does not take into account any specific renovation, upgrade, split, merge, or deterioration of the unit.*

## Building Information

Number of units: 240  
 Number of active listings for rent: 0  
 Number of active listings for sale: 18  
 Building inventory for sale: 7%  
 Number of sales over the last 12 months: 21  
 Number of sales over the last 6 months: 8  
 Number of sales over the last 3 months: 1

## Building Association Information

Villa Sonoma At International Plaza Condominium Association, Inc  
 4221 W Spruce Street Tampa, FL 33607  
 Phone: (813) 877-8899

## Recent Sales

Unit #	Size	Closing Date	Sale Price	PPSF
2324	792 sq ft	Jul 2024	\$245,000	\$309
2402	800 sq ft	May 2024	\$244,000	\$305
2224	792 sq ft	May 2024	\$232,000	\$293
2323	696 sq ft	Apr 2024	\$225,000	\$323
2109	800 sq ft	Apr 2024	\$229,000	\$286
2407	1,447 sq ft	Apr 2024	\$440,000	\$304
2312	992 sq ft	Apr 2024	\$300,000	\$302
1321	696 sq ft	Apr 2024	\$245,000	\$352

## Market Information

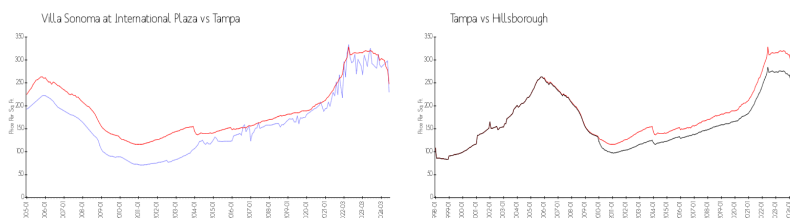

Villa Sonoma at International Plaza:	\$230/sq. ft.	Tampa:	\$248/sq. ft.
Tampa:	\$248/sq. ft.	Hillsborough:	\$190/sq. ft.

## Inventory for Sale

Villa Sonoma at International Plaza 8%  
 Tampa 2%  
 Hillsborough 2%

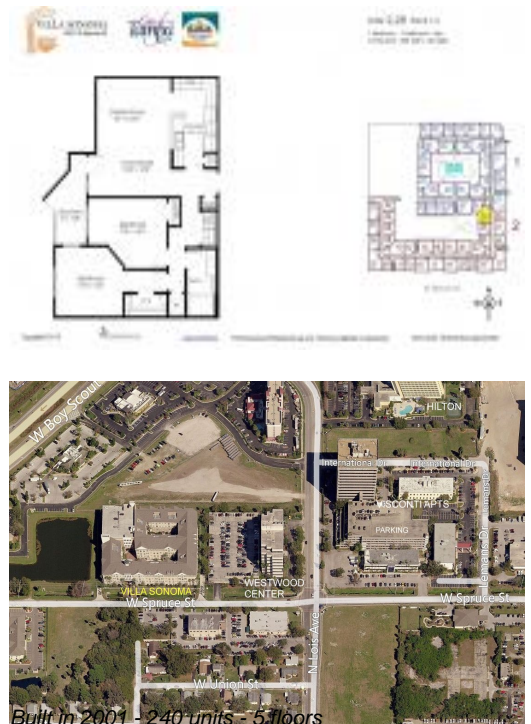

**Avg. Time to Close Over Last 12 Months**

Villa Sonoma at International Plaza	55 days
Tampa	54 days
Hillsborough	55 days