

Unit 4203 - Porsche Design Tower

4203 - 18555 Collins Ave, Sunny Isles, FL, Miami-Dade 33160

Unit Information

MLS Number: A11543980
 Status: Active
 Size: 6,844 Sq ft.
 Bedrooms: 5
 Full Bathrooms: 6
 Half Bathrooms: 2
 Parking Spaces: 2 Or More Spaces, Additional Spaces Available, Other Parking

View:
 List Price: \$15,000,000
 List PPSF: \$2,192
 Valuated Price: \$5,136,000
 Valuated PPSF: \$1,641

The above valuated price is a baseline figure that does not take into account any specific renovation, upgrade, split, merge, or deterioration of the unit.

Building Information

Number of units: 132
 Number of active listings for rent: 0
 Number of active listings for sale: 36
 Building inventory for sale: 27%
 Number of sales over the last 12 months: 5
 Number of sales over the last 6 months: 3
 Number of sales over the last 3 months: 1

Building Association Information

Porsche Design Tower Miami
 18555 Collins Avenue
 Sunny Isles Beach, FL 33160
 Main number (305) 800-9111

Recent Sales

Unit #	Size	Closing Date	Sale Price	PPSF
5403	3,130 sq ft	Feb 2024	\$4,800,000	\$1,534
1703	4,154 sq ft	Dec 2023	\$3,600,000	\$867
5201	6,121 sq ft	Dec 2023	\$10,500,000	\$1,715
901	3,415 sq ft	Sep 2023	\$4,400,000	\$1,288
905	3,415 sq ft	Jul 2023	\$3,990,000	\$1,168

Market Information

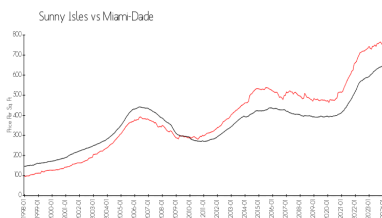
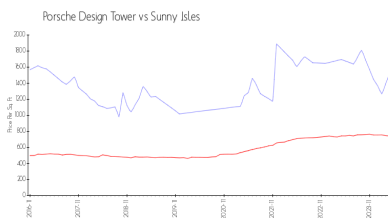

Porsche Design Tower:	\$1529/sq. ft.	Sunny Isles:	\$743/sq. ft.
Sunny Isles:	\$743/sq. ft.	Miami-Dade:	\$698/sq. ft.

Inventory for Sale

Porsche Design Tower: 27%
 Sunny Isles: 5%
 Miami-Dade: 3%

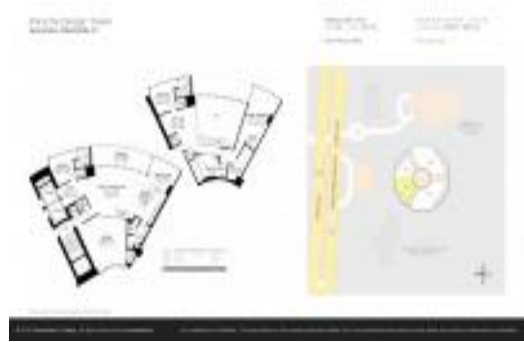

Avg. Time to Close Over Last 12 Months

Porsche Design Tower	124 days
Sunny Isles	113 days
Miami-Dade	81 days