

Unit 1914 - Isola Brickell Key

1914 - 770 Claughton Island Dr, Miami, FL, Miami-Dade 33131

Unit Information

MLS Number:	A11706464
Status:	Active Under Contract
Size:	985 Sq ft.
Bedrooms:	2
Full Bathrooms:	2
Half Bathrooms:	0
Parking Spaces:	2 Or More Spaces,Covered Parking
View:	
List Price:	\$552,000
List PPSF:	\$560
Valuated Price:	\$473,000
Valuated PPSF:	\$480

The above valuated price is a baseline figure that does not take into account any specific renovation, upgrade, split, merge, or deterioration of the unit.

Building Information

Number of units:	300
Number of active listings for rent:	23
Number of active listings for sale:	19
Building inventory for sale:	6%
Number of sales over the last 12 months:	10
Number of sales over the last 6 months:	9
Number of sales over the last 3 months:	4

Building Association Information

Isola Brickell Key Condo association
305-371-7007

<https://>

Recent Sales

Unit #	Size	Closing Date	Sale Price	PPSF
PH-26	735 sq ft	Dec 2025	\$360,000	\$490
1912	682 sq ft	Sep 2025	\$315,000	\$462
1414	985 sq ft	Sep 2025	\$499,000	\$507
1915	1,065 sq ft	Sep 2025	\$500,000	\$469
PH-18	1,086 sq ft	Sep 2025	\$455,600	\$420

Market Information

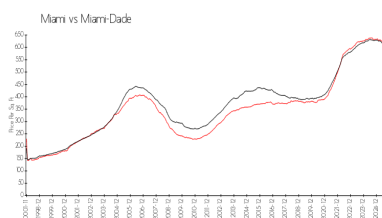

Isola Brickell Key: \$469/sq. ft.
Miami: \$629/sq. ft.

Miami: \$629/sq. ft.
Miami-Dade: \$668/sq. ft.

Inventory for Sale

Isola Brickell Key	6%
Miami	5%
Miami-Dade	4%

Avg. Time to Close Over Last 12 Months

Isola Brickell Key	72 days
--------------------	---------

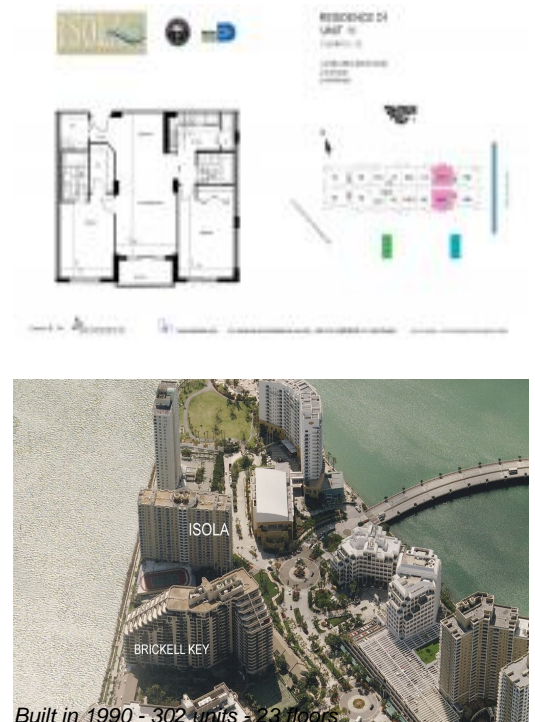

Miami
Miami-Dade

70 days
77 days