

Unit 208 - Sandpointe Bay

208 - 19800 Sandpointe Bay Dr, Jupiter, FL, Palm Beach 33469

Unit Information

MLS Number: RX-10942438
 Status: Active
 Size: 1,639 Sq ft.
 Bedrooms: 2
 Full Bathrooms: 2
 Half Bathrooms: 1
 Parking Spaces: Assigned, Carport - Detached, Guest, Vehicle Restrictions
 View: Intracoastal, Pool
 List Price: \$799,900
 List PPSF: \$488
 Valuated Price: \$758,000
 Valuated PPSF: \$462

The above valuated price is a baseline figure that does not take into account any specific renovation, upgrade, split, merge, or deterioration of the unit.

Building Information

Number of units: 95
 Number of active listings for rent: 0
 Number of active listings for sale: 2
 Building inventory for sale: 2%
 Number of sales over the last 12 months: 2
 Number of sales over the last 6 months: 2
 Number of sales over the last 3 months: 1

Building Association Information

Sandpointe Bay Condo Association
 19800 Sandpointe Bay Dr
 Tequesta FL 33469-2362
 (561) 747-1496
 (561) 747-4707

Recent Sales

Unit #	Size	Closing Date	Sale Price	PPSF
312	2,075 sq ft	Feb 2024	\$1,025,000	\$494
507	1,848 sq ft	Nov 2023	\$875,000	\$473

Market Information

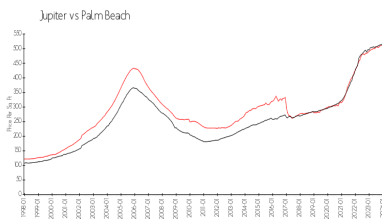
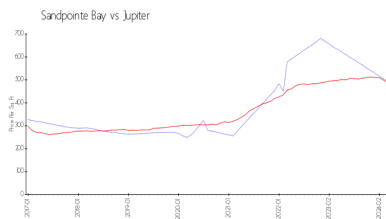

Sandpointe Bay: \$493/sq. ft.
 Jupiter: \$489/sq. ft.
 Jupiter: \$489/sq. ft.
 Palm Beach: \$467/sq. ft.

Inventory for Sale

Sandpointe Bay 2%
 Jupiter 3%
 Palm Beach 3%

Avg. Time to Close Over Last 12 Months

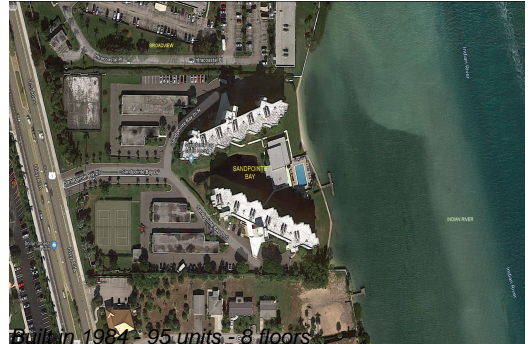
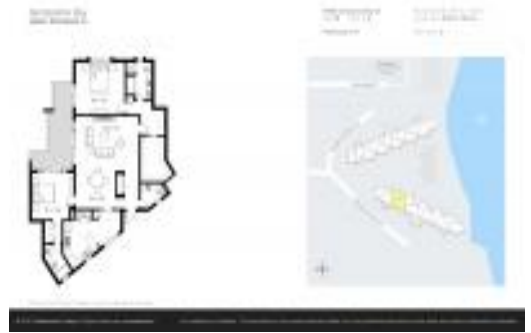

Sandpointe Bay
Jupiter
Palm Beach

n/a
65 days
56 days