

Unit 205 - Sandpointe Bay

205 - 19800 Sandpointe Bay Dr, Jupiter, FL, Palm Beach 33469

Unit Information

MLS Number:	RX-10966446
Status:	Active
Size:	1,639 Sq ft.
Bedrooms:	2
Full Bathrooms:	2
Half Bathrooms:	1
Parking Spaces:	Assigned
View:	Intracoastal
List Price:	\$795,000
List PPSF:	\$485
Valuated Price:	\$758,000
Valuated PPSF:	\$462

The above valuated price is a baseline figure that does not take into account any specific renovation, upgrade, split, merge, or deterioration of the unit.

Building Information

Number of units:	95
Number of active listings for rent:	0
Number of active listings for sale:	2
Building inventory for sale:	2%
Number of sales over the last 12 months:	2
Number of sales over the last 6 months:	2
Number of sales over the last 3 months:	1

Building Association Information

Sandpointe Bay Condo Association
 19800 Sandpointe Bay Dr
 Tequesta FL 33469-2362
 (561) 747-1496
 (561) 747-4707

Recent Sales

Unit #	Size	Closing Date	Sale Price	PPSF
312	2,075 sq ft	Feb 2024	\$1,025,000	\$494
507	1,848 sq ft	Nov 2023	\$875,000	\$473

Market Information

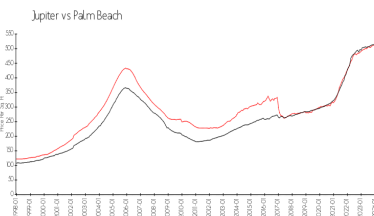
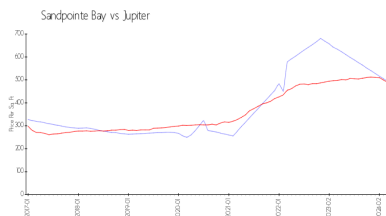

Sandpointe Bay:	\$493/sq. ft.	Jupiter:	\$489/sq. ft.
Jupiter:	\$489/sq. ft.	Palm Beach:	\$467/sq. ft.

Inventory for Sale

Sandpointe Bay	2%
Jupiter	3%
Palm Beach	3%

Avg. Time to Close Over Last 12 Months

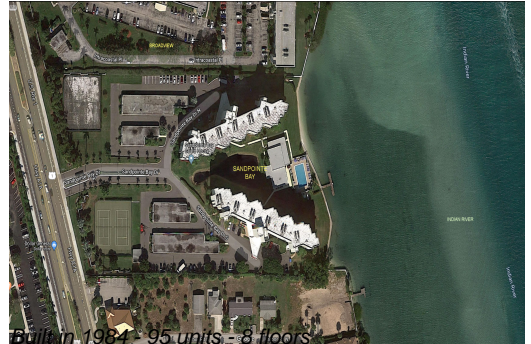
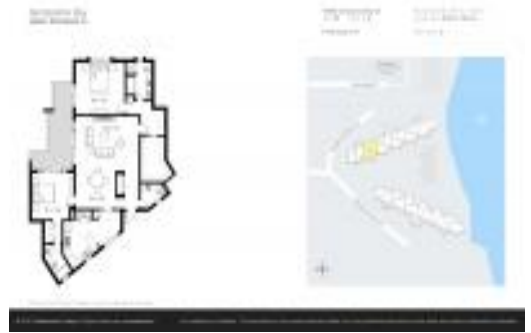

Sandpointe Bay
Jupiter
Palm Beach

n/a
65 days
56 days