

# Unit 207 Wellington M - Wellington A-M

207 Wellington M - 101-314 Wellington A, West Palm Beach, FL, Palm Beach 33417

## Unit Information

MLS Number: RX-11028827  
 Status: Active  
 Size: 912 Sq ft.  
 Bedrooms: 1  
 Full Bathrooms: 1  
 Half Bathrooms: 1  
 Parking Spaces: Assigned, Guest, Vehicle Restrictions  
 View: Lake  
 List Price: \$90,000  
 List PPSF: \$99  
 Valuated Price: \$161,000  
 Valuated PPSF: \$187

*The above valuated price is a baseline figure that does not take into account any specific renovation, upgrade, split, merge, or deterioration of the unit.*

## Building Information

Number of units: 560  
 Number of active listings for rent: 0  
 Number of active listings for sale: 22  
 Building inventory for sale: 3%  
 Number of sales over the last 12 months: 26  
 Number of sales over the last 6 months: 11  
 Number of sales over the last 3 months: 5

## Recent Sales

Unit #	Size	Closing Date	Sale Price	PPSF
	1,152 sq ft	Jan 2025	\$210,000	\$182
	1,152 sq ft	Jan 2025	\$210,000	\$182
	1,152 sq ft	Dec 2024	\$189,000	\$164
E	1,152 sq ft	Dec 2024	\$215,000	\$187
	1,152 sq ft	Nov 2024	\$150,000	\$130

## Market Information

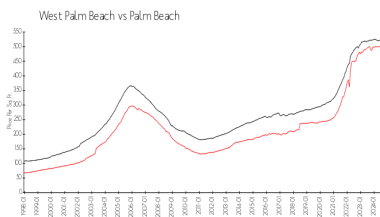
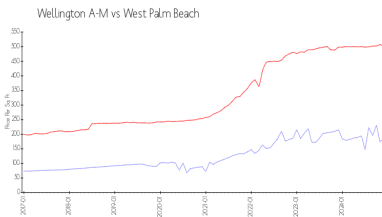

Wellington A-M: \$187/sq. ft.      West Palm Beach: \$502/sq. ft.  
 West Palm Beach: \$502/sq. ft.      Palm Beach: \$464/sq. ft.

## Inventory for Sale

Wellington A-M: 4%  
 West Palm Beach: 4%  
 Palm Beach: 4%

## Avg. Time to Close Over Last 12 Months

Wellington A-M: 14 days  
 West Palm Beach: 56 days  
 Palm Beach: 62 days

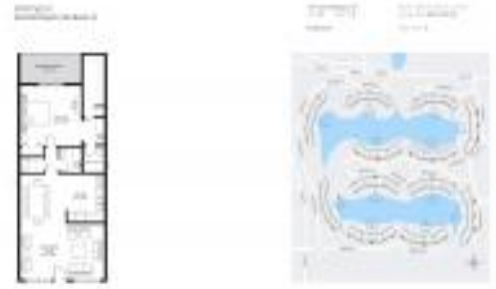

Built in 1971 - 560 units - 4 floors