

# Unit 168 Wellington J - Wellington A-M

168 Wellington J - 101-314 Wellington A, West Palm Beach, FL, Palm Beach 33417

## Unit Information

MLS Number:	RX-11042673
Status:	Active
Size:	1,152 Sq ft.
Bedrooms:	2
Full Bathrooms:	2
Half Bathrooms:	0
Parking Spaces:	Assigned
View:	Lake,Pond
List Price:	\$295,000
List PPSF:	\$256
Valuated Price:	\$188,000
Valuated PPSF:	\$172

The above valuated price is a baseline figure that does not take into account any specific renovation, upgrade, split, merge, or deterioration of the unit.

## Building Information

Number of units:	560
Number of active listings for rent:	0
Number of active listings for sale:	22
Building inventory for sale:	3%
Number of sales over the last 12 months:	26
Number of sales over the last 6 months:	10
Number of sales over the last 3 months:	5

## Recent Sales

Unit #	Size	Closing Date	Sale Price	PPSF
	1,152 sq ft	Dec 2024	\$189,000	\$164
E	1,152 sq ft	Dec 2024	\$215,000	\$187
	1,152 sq ft	Nov 2024	\$150,000	\$130
	1,152 sq ft	Oct 2024	\$215,000	\$187
	1,152 sq ft	Oct 2024	\$290,000	\$252

## Market Information

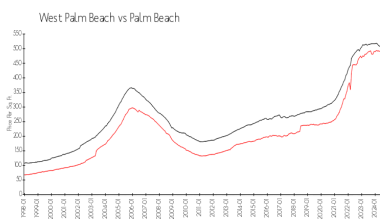
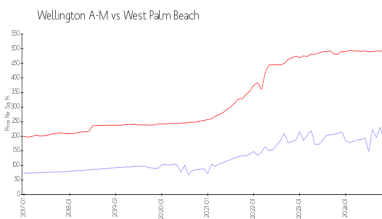

Wellington A-M:	\$174/sq. ft.	West Palm Beach:	\$496/sq. ft.
West Palm Beach:	\$496/sq. ft.	Palm Beach:	\$466/sq. ft.

## Inventory for Sale

Wellington A-M	4%
West Palm Beach	4%
Palm Beach	4%

## Avg. Time to Close Over Last 12 Months

Wellington A-M	5 days
West Palm Beach	55 days
Palm Beach	61 days

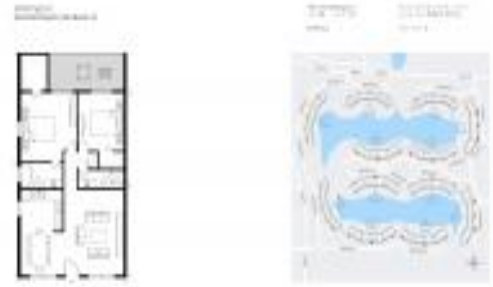

Built in 1971 - 560 units - 4 floors